

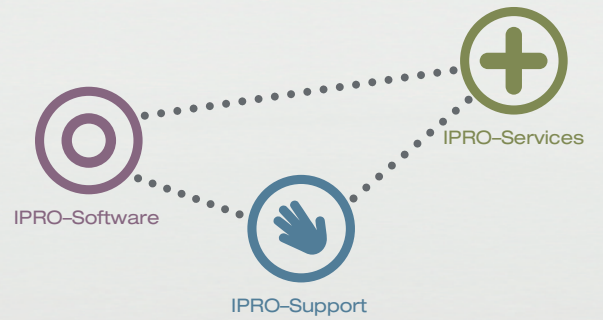

## IPAD APP IPRO EYETEST



# The iPad App “IPRO EyeTest”

The new professional near vision test for the Apple iPad in English.

Professional near vision testing is becoming increasingly important for the Optometrists' practice. At the same time, it becomes obvious how limited the variety of the classic near vision test instruments is. In most cases, their design is also quite old-fashioned, to put it mildly.

The professional IPRO EyeTests, with their numerous Test-Charts, can not only replace the previous near vision instruments completely, they also show your competence in up-to-date testing. The typical features of the Apple iPad create a near test experience which your patients will love.

The Optometrist can put together individual test sequences from more than 40 monocular and binocular test-charts plus additional screening tests

Red-green separation of the bifocal tests can be individually set.  
A further advantage of the IPRO EyeTest is the training effect:  
Additional background knowledge is available for many tests.

“It brings a smile to the faces of my customers”, says Kay Dollt

“For a long time we have been looking for a good and spectacular vision test tool, to offer something new to our patients. A near vision test on the iPad is the perfect idea.

The device is pure fun to hold and use, and the patients are fascinated by it.”

“As there hasn't been any comprehensive software available in the AppStore yet, I am very pleased that IPRO initiated the creation of the EyeTest.  
We have taken part in designing the App and could thereby contribute to the project with our own ideas and requirements.”

“We started testing the App in our practice right at the beginning of the Beta-Phase. And the effect is exactly what I expected it to be:  
It brings a smile to the faces of my patients!”

The IPRO Eye Test App is available from the App-Store. Just follow this link:  
<http://itunes.apple.com/uk/app/ipro-eyetest/id411276739?mt=8>  
or at <http://iproeyetest.com>

# Quick Guide

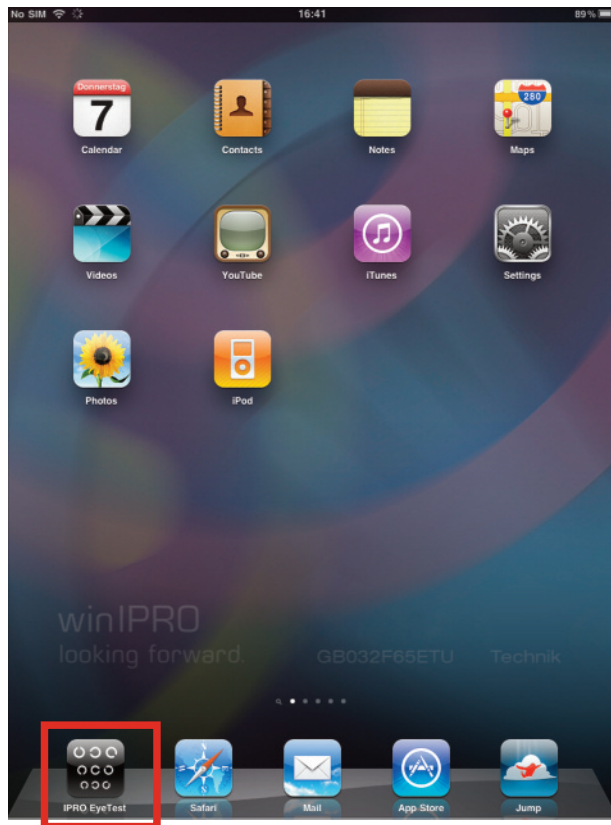

Tab on the icon to start the **IPRO Eye Test-App**

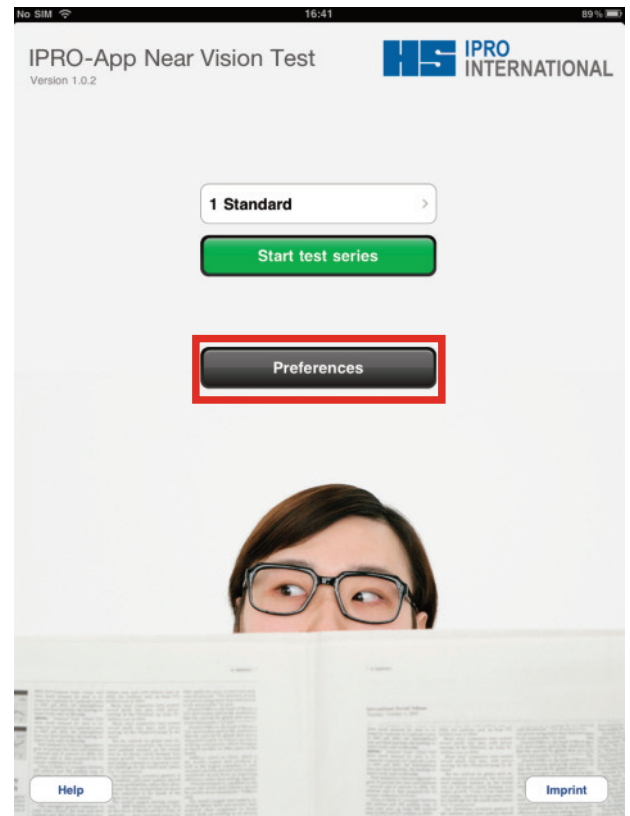

Tab on preferences to create an individual test series

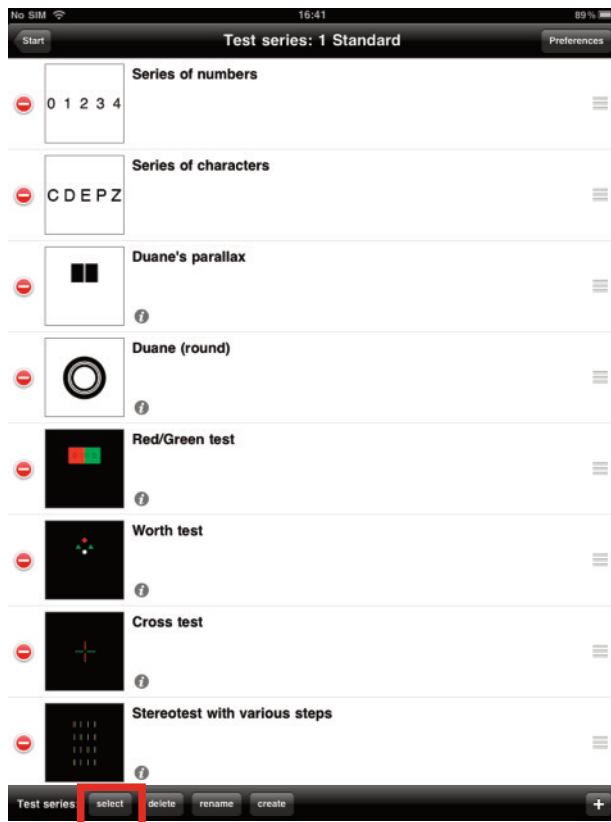

Now, please tab on select test series

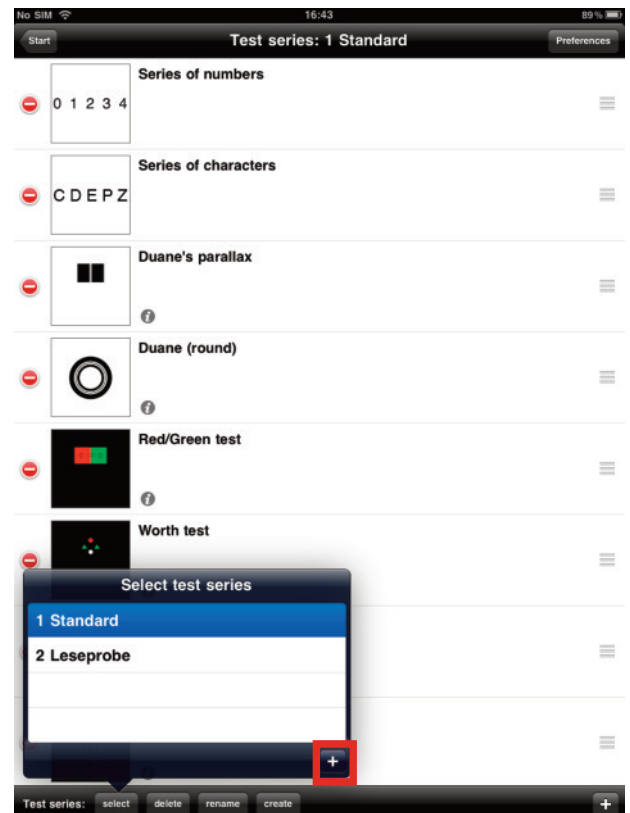

Now, tab on the + to create a new test series

# Quick Guide

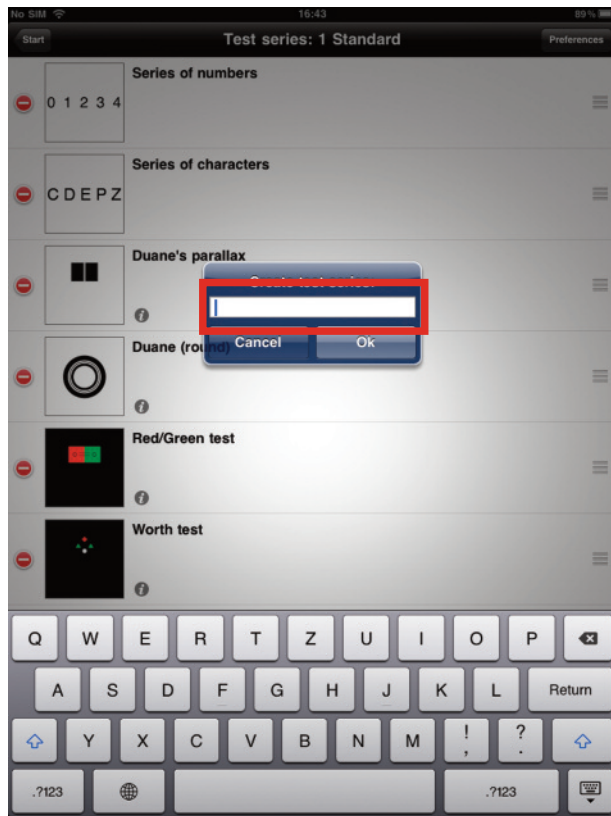

Now, enter the name of your new test series

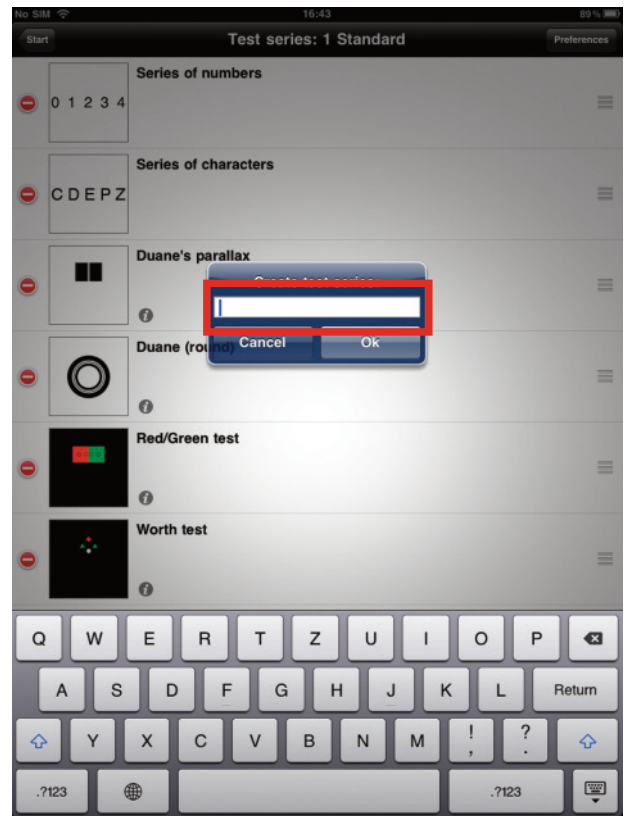

Here called **New Test Series**

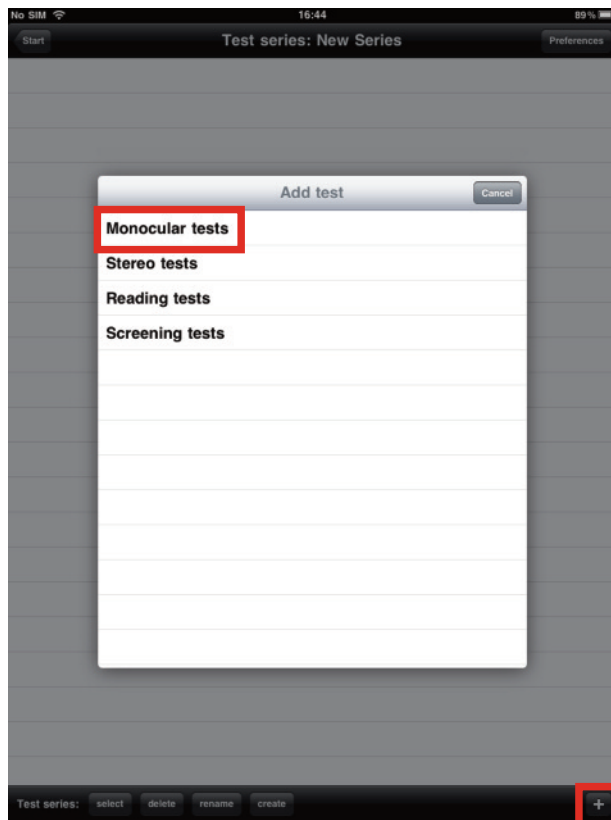

To add a test chart, tab on the + in the bottom right hand corner, now elect a category.

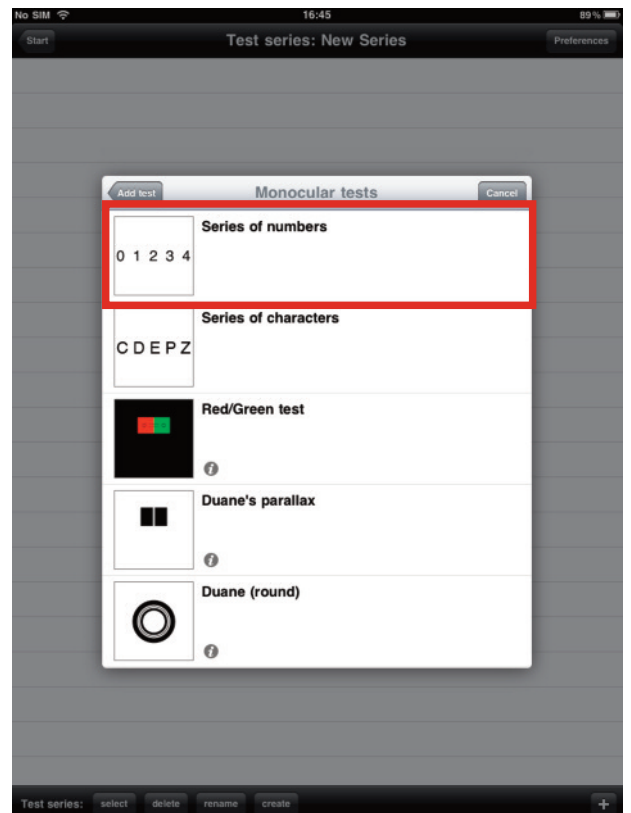

To add a specific test, just tab on it

# Quick Guide

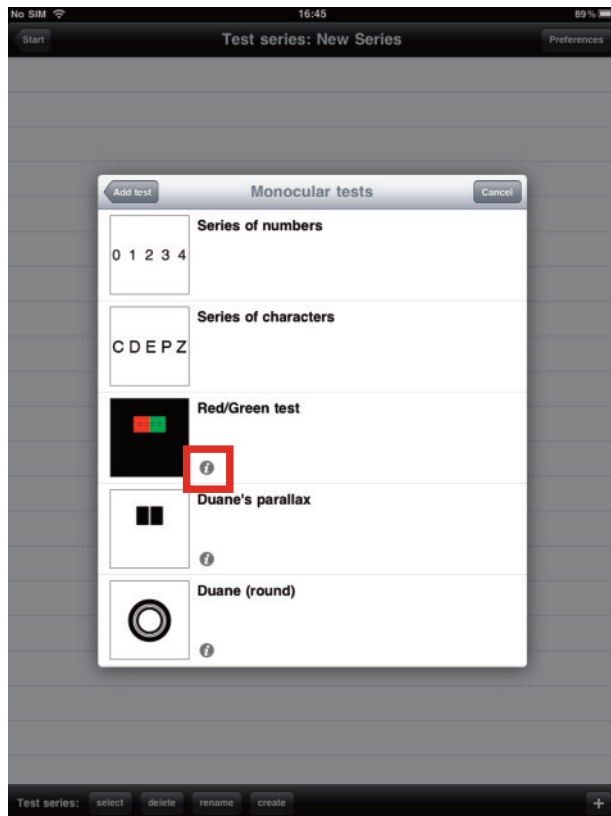

To see further info about the respective test, tab on the **i**

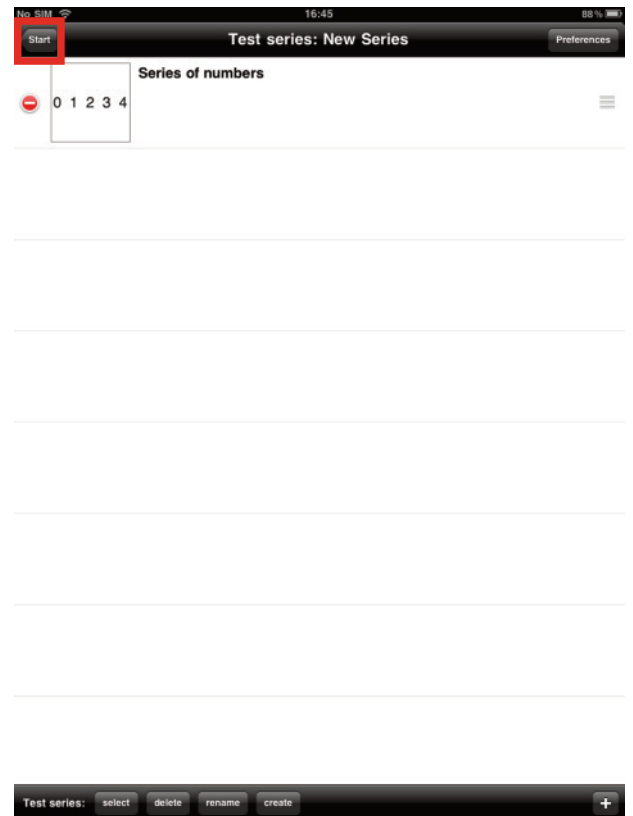

Now the test has been added to your test series. Tab on **Start** to have the initial screen displayed

# Working with the App

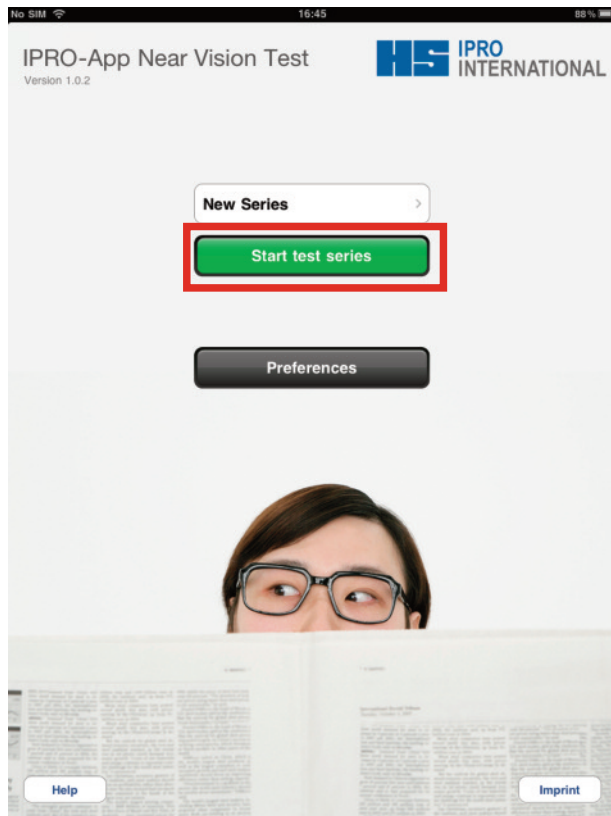

To start your new test series, tab on Start test series. The test begins.



To change only the numbers, tab on them.



5 9 0 4 3



For this test, additional functions for changing the characters and size are available

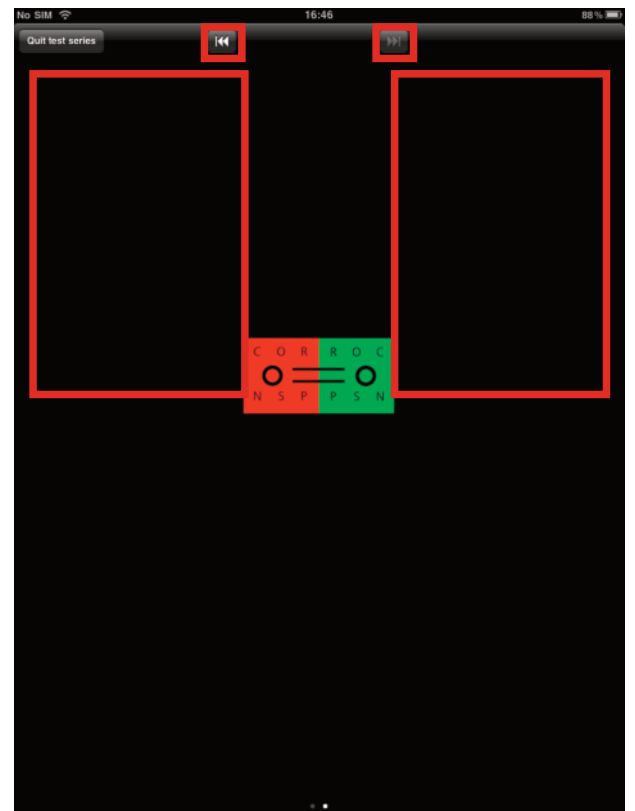

To move to the next test, tab in the upper right-hand area of the screen. To go back, tab in the left-hand area.

# Available tests

Series of numbers VA 6/24	Pointer test
Series of numbers VA 6/20	Double-pointer test
Series of numbers VA 6/15	Contrast test (level 1)
Series of numbers VA 6/12	Contrast test (level 2)
Series of numbers VA 6/10	Convergence bar
Series of numbers VA 6/7.5	Stereotest (fine)
Red/Green test	Maddox test
Duane's parallax	Graefe test
Duane (round)	Near fusion
Worth test	Near fixation
Schober test	Schober test (large)
Reading test VA 6/20	Ishihara colour charts 1
Reading test VA 6/15	Ishihara colour charts 2
Reading test VA 6/12	Ishihara colour charts 3
Reading test VA 6/10	Ishihara colour charts 4
Reading test VA 6/7.5	
Reading test with VA gradation	
Reading test VA 6/20 (negative)	
Reading test VA 6/15 (negative)	
Reading test VA 6/12 (negative)	
Reading test VA 6/10 (negative)	
Reading test VA 6/7.5 (negative)	
Reading test with VA gradation (negative)	
Red/Green test (steps)	
Red/Green test (reading test)	
Near astigmatism	
Near astigmatism 2	
Amsler chart (black)	
Amsler chart (white, rough)	
Cross pattern	
Near exophoria	
Coincidence test (vertical)	
Cross test	
Stereotest with various steps	